

特殊銅合金系

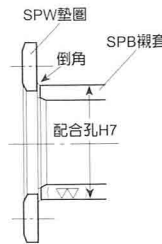

運動方向

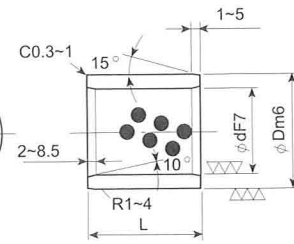
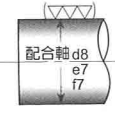

●配合軸d8：一般用（高負荷）
e7：一般用（輕負荷）
f7：高精度用

●若承受軸向負荷時須配合
SPW組合使用。

自潤#500SP
襯套(SPB)
迴轉（搖擺）· 往復運動用

使用注意事項

- 自潤#500SP襯套(SPB)在迴轉，搖擺及往復運動均可使用。
- 若承受軸向荷重時，請配合自潤#500SP墊圈(SPW)組合使用。
- 請避免在水中使用。
- 內徑31.5mm在油壓缸中間耳軸(trunnion)襯套。

※特殊規格尺寸亦可訂製。
※特殊條件及場所之使用請另洽本公司。

訂購型號
SPB-○○ ○○ ○○
內徑 外徑 長度

軸徑 區分	寸法 (mm)		長度 L 公差 ⁰ _{0.3}										長度 L 公差 ^{-0.1} _{0.3}										內徑	外徑	適用 墊圈 SPW		
	內徑	外徑	8	10	12	15	16	20	25	30	35	40	50	60	70	80	100	120	130	140	150						
	φd 公差	φD 公差	SPB	SPB	SPB	SPB	SPB	SPB	SPB	SPB	SPB	SPB	SPB	SPB	SPB	SPB	SPB	SPB	SPB	SPB	SPB						
8	8	+0.028 +0.013	12	+0.018 +0.007	-081208	-081210	-081212	-081215														8	12	—			
10	10	"	14	"	-101408	-101410	-101412	-101415			-101420											10	14	-1003			
12	12	+0.034 +0.016	18	"	-121808	-121810	-121812	-121815		-121816	-121820	-121825	-121830									12	18	-1203			
13	13	"	19	+0.021 +0.008		-131910	-131912	-131915			-131920											13	19	-1303			
14	14	"	20	"		-142010	-142012	-142015			-142020	-142025	-142030									14	20	-1403			
15	15	"	21	"		-152110	-152112	-152115	-152116	-152120	-152125	-152130										15	21	-1503			
16	16	"	22	"		-162210	-162212	-162215	-162216	-162220	-162225	-162230	-162235									16	22	-1603			
18	18	"	24	"		-182412	-182415	-182416	-182420	-182425	-182430											18	24	-1803			
20	20	+0.041 +0.020	28	"		-202810	-202812	-202815	-202816	-202820	-202825	-202830	-202835		-202840	-202850						20	28	-2005			
	20	"	30	"					-203016	-203020	-203025	-203030	-203035		-203040							20	30	"			
25	25	"	33	+0.025 +0.009		-253312	-253315	-253316	-253320	-253325	-253330	-253335		-253340	-253350	-253360						25	33	-2505			
	25	"	35	"		-253512	-253515	-253516	-253520	-253525	-253530	-253535		-253540	-253550							25	35	"			
30	30	"	38	"		-303812	-303815		-303820	-303825	-303830	-303835		-303840	-303850	-303860						30	38	-3005			
	30	"	40	"		-304012	-304015		-304020	-304025	-304030	-304035		-304040	-304050	-304060						30	40	"			
31.5	31.5	+0.050 +0.025	40	"							-314030			-314040								31.5	40	—			
35	35	"	44	"						-354425	-354430	-354435		-354440	-354450	-354460						35	44	-3505			
	35	"	45	"					-354520	-354525	-354530	-354535		-354540	-354550	-354560						35	45	"			
40	40	"	50	"			-405015		-405020	-405025	-405030	-405035		-405040	-405050	-405060	-405070	-405080				40	50	-4007			
	40	"	55	+0.030 +0.011							-405530	-405535		-405540	-405550	-405560						40	55	"			
	45	"	55	"							-455530	-455535		-455540	-455550	-455560						45	55	-4507			
45	45	"	56	"							-455630	-455635		-455640	-455650	-455660						45	56	"			
	45	"	60	"							-456030	-456035		-456040	-456050	-456060	-456070	-456080				45	60	"			
50	50	"	60	"					-506020		-506030	-506035		-506040	-506050	-506060	-506070	-506080				50	60	-5008			
	50	"	62	"							-506230	-506235		-506240	-506250	-506260	-506270					50	62	"			
	50	"	65	"							-506530			-506540	-506550	-506560	-506570	-506580	-5065100				50	65	"		
55	55	+0.060 +0.030	70	"							-557030	-557035		-557040	-557050	-557060	-557070					55	70	-5508			
60	60	"	74	"							-607430	-607435		-607440	-607450	-607460	-607470	-607480				60	74	-6008			
	60	"	75	"							-607530	-607535		-607540	-607550	-607560	-607570	-607580	-6075100				60	75	"		
63	63	"	75	"											-637560	-637570	-637580					63	75	—			
65	65	"	80	"										-658040	-658050	-658060	-658070	-658080				65	80	-6508			
70	70	"	85	+0.035 +0.013							-708530	-708535		-708540	-708550	-708560	-708570	-708580	-7085100				70	85	-7010		
	70	"	90	"											-709050	-709060	-709070	-709080				70	90	"			
75	75	"	90	"											-759050	-759060	-759070	-759080	-7590100				75	90	-7510		
	75	"	95	"											-759560	-759570	-759580	-7595100				75	95	"			
80	80	"	96	"										-809640	-809650	-809660	-809670	-809680	-8096100	-8096120				80	96	-8010	
	80	"	100	"										-8010040	-8010050	-8010060	-8010070	-8010080	-80100100	-80100120	-80100140				80	100	"
90	90	+0.071 +0.036	110	"											-9011050	-9011060		-9011080	-90110100	-90110120				90	110	-9010	
100	100	"	120	"											-10012050	-10012060	-10012070	-10012080	-100120100	-100120120	-100120140				100	120	-10010
110	110	"	130	+0.040 +0.015											-11013050		-11013070	-11013080	-110130100	-110130120				110	130	—	
120	120	"	140	"												-12014070	-12014080	-120140100	-120140120	-120140140				120	140	-12010	
125	125	+0.083 +0.043	145	"												-125145100	-125145120								125	145	—
130	130	"	150	"													-13015080	-130150100		-130150130					130	150	—
140	140	"	160	"													-140160100			-140160140					140	160	—
150	150	"	170	"													-15017080	-150170100			-150170150				150	170	—
160	160	"	180	"													-16018080	-160180100			-160180150				160	180	—