

# SWS / SWSS

開縫型 / 止付螺絲固定式 / 撓性聯軸器  
COUPLING / SHORT-SLITTED SET SCREW TYPE

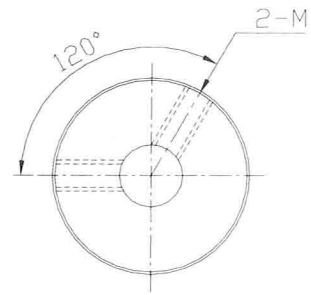
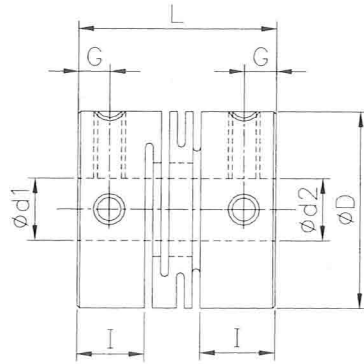

## 尺寸 / Dimension

單位 / Unit : mm

Catalog Number 型號	D	I	L	G	M	d1xd2 標準孔徑 公差 (H8)		Mass** 質量 (g)
						Min	Max	
<b>SWS-16</b>	16	6.8	18	3	M3	5	6	7.4
<b>SWS-20</b>	20	7.65	20	3	M4	5	10	12
<b>SWS-25</b>	25	9.6	25	4	M4	6	12	24
<b>SWS-32</b>	32	12.6	32	6	M5	6	14	50
<b>SWSS-16</b>	16	6.8	18	3	M3	5	6	18
<b>SWSS-20</b>	20	7.65	20	3	M4	5	10	32
<b>SWSS-25</b>	25	9.6	25	4	M4	6	12	63
<b>SWSS-32</b>	32	12.6	32	6	M5	6	14	130

## 性能 / Function

Catalog Number 型號	Rated Torque 一般扭力 (N.m)	Max. Torque 最大扭力 (N.m)	Max. Rotational Frequency 最高回轉數 (min <sup>-1</sup> )	Moment* of Inertia 慣性 (kg·m <sup>2</sup> )	Static Torsional Stiffness 剛性靜扭力值 (N.m/rad)	Errors of Angularity 容許偏角 (°)	Errors of Shaft End-Play 容許軸向位差 (mm)
<b>SWS-16</b>	0.3	0.6	24000	$2.8 \times 10^{-7}$	110	1	±0.2
<b>SWS-20</b>	0.5	1	19000	$7.5 \times 10^{-7}$	130	1	±0.2
<b>SWS-25</b>	1	2	15000	$2.3 \times 10^{-6}$	350	1	±0.2
<b>SWS-32</b>	2	4	12000	$8.0 \times 10^{-6}$	650	1	±0.2
<b>SWSS-16</b>	0.5	1	24000	$7.2 \times 10^{-7}$	240	1	±0.1
<b>SWSS-20</b>	1	2	19000	$2.0 \times 10^{-6}$	330	1	±0.1
<b>SWSS-25</b>	2	4	15000	$6.1 \times 10^{-6}$	720	1	±0.2
<b>SWSS-32</b>	3.5	7	12000	$2.1 \times 10^{-5}$	1300	1	±0.2

## 材質 / Material:

SWS 系列—鋁合金 / Aluminum alloy  
SWSS 系列—不銹鋼 / Stainless steel

## 特性 / Features

1. 一體成型、小巧 / One-body shape.
2. 零背隙 / Zero backlash.
3. 剛性大 / High rigid.
4. 偏角誤差較佳 / High deflection.
5. 固定方式：固定螺絲式 / Fixed mode: Set screw type.

## 型號表示 / Product NO:

**SWS-20 - Ø6 x Ø6**

型號 / Type

孔徑 / Inside dia